

BCA 2

BOWL TIPPER

The BCA 2 is a mobile bowl tipper, with left or right discharge, which allows the transfer of the dough contained in the bowl to a volumetric divider, in a single operation.

The bowl tippers are used with the SPI A range of mixers.



technical data	
Tipping at the back	✓
Low tipping to a table	✓
Weight	360
connections	
Electrical supply	400V~TRI+T/50-60Hz
Power	1,13 kW
Rated current	3 A

legend

✓ standard

Features

- + Welded steel frame with food-grade epoxy paint.
- + Equipped with a double safety device at the end of the stroke, high position.
- + Supplied with anchors for a compulsory sealing in the ground for the safety of operation.
- + Equipped with a hydraulic lifting system for maximum safety.

Control panel

- 1 - Voltage presence indicator.
- 2 - Up push-button.
- 3 - Down push-button.
- 4 - Emergency push-button.

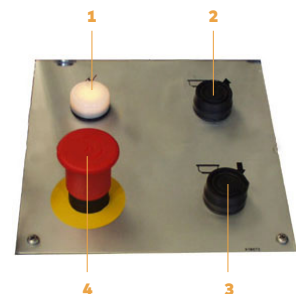

NON CONTRACTUAL DATA

IMPLEMENTATION

DIMENSIONS AND CONNECTIONS

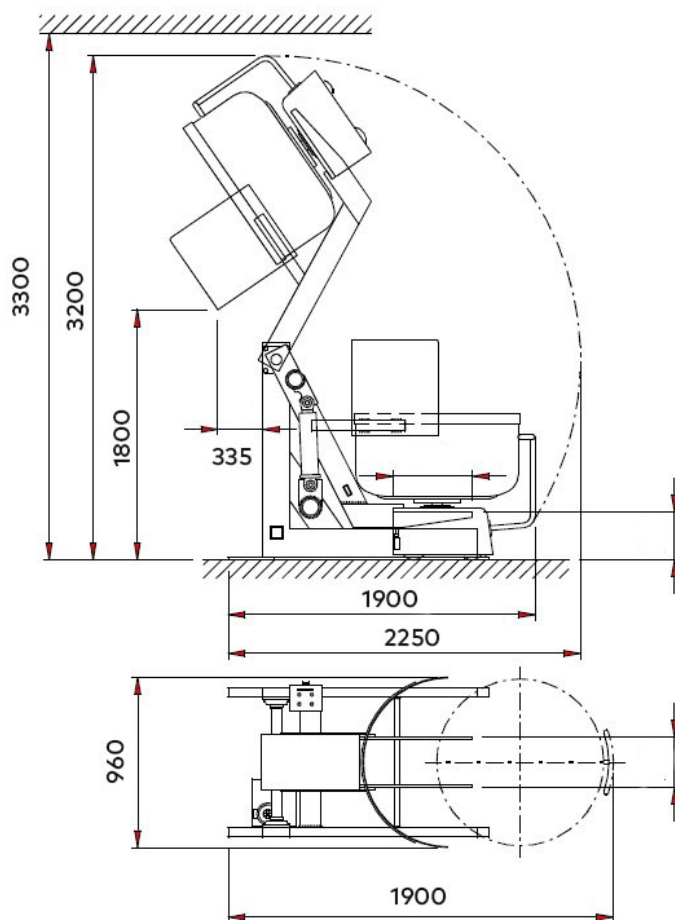

Triphase electrical plug connection

Pavailler Solution:
Triphase electrical
cable provided

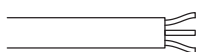

At customer's charge:
PLUG connection male and
female ht 1,20m.

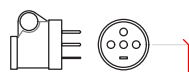

Benefits
Limits

1,20m

electrical installation principle



MANY AND MORE, REAL GOODS

BERTRAND-PUMA - Rue Benoit Frachon - 26800 PORTES-LES-VALENCE (France)
Tél : +33 (0) 475 575 500 - Email : contact@sebp-bertrand.com